

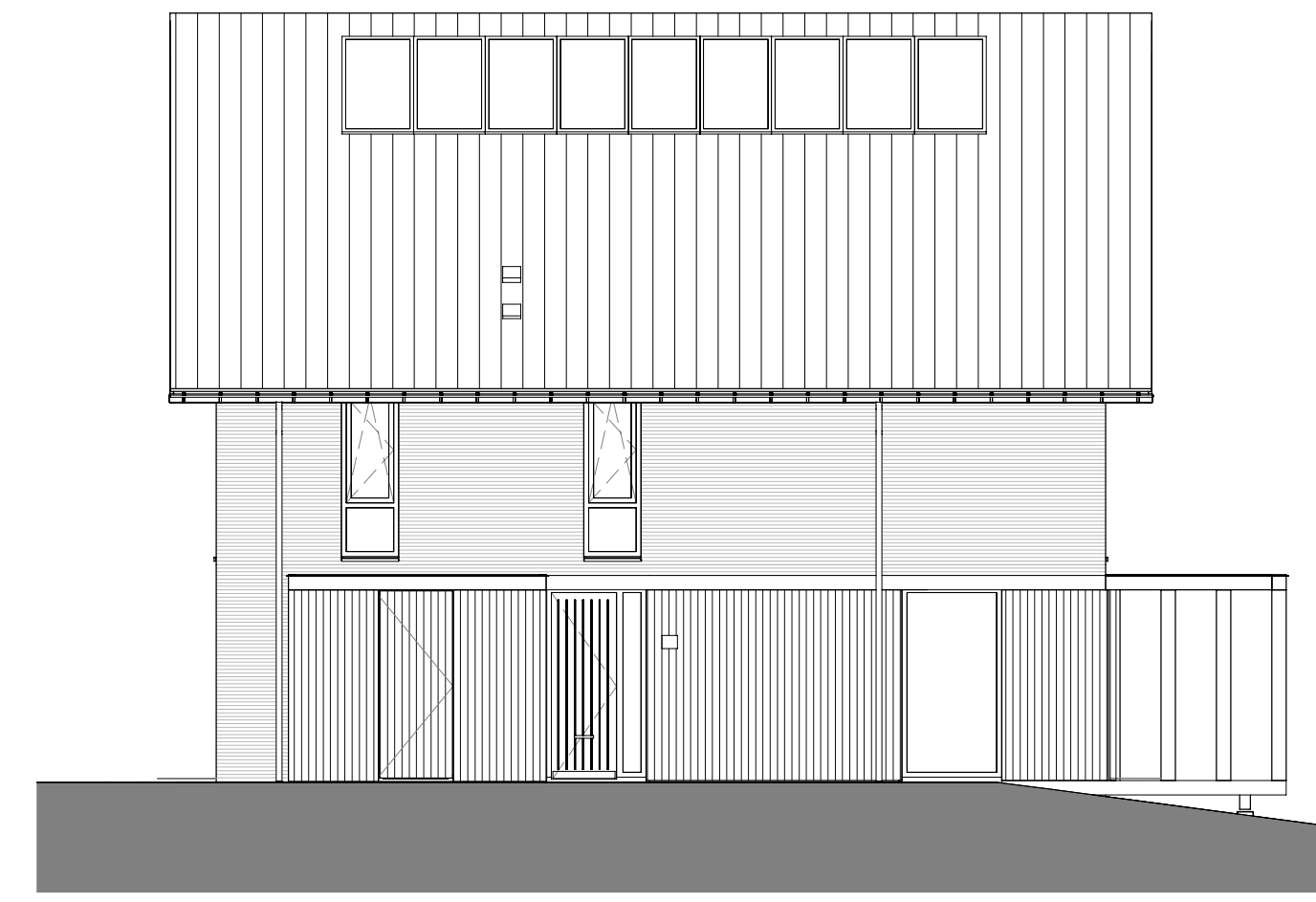

voorgevel

schaal 1 : 100



linker zijgevel

schaal 1 : 100

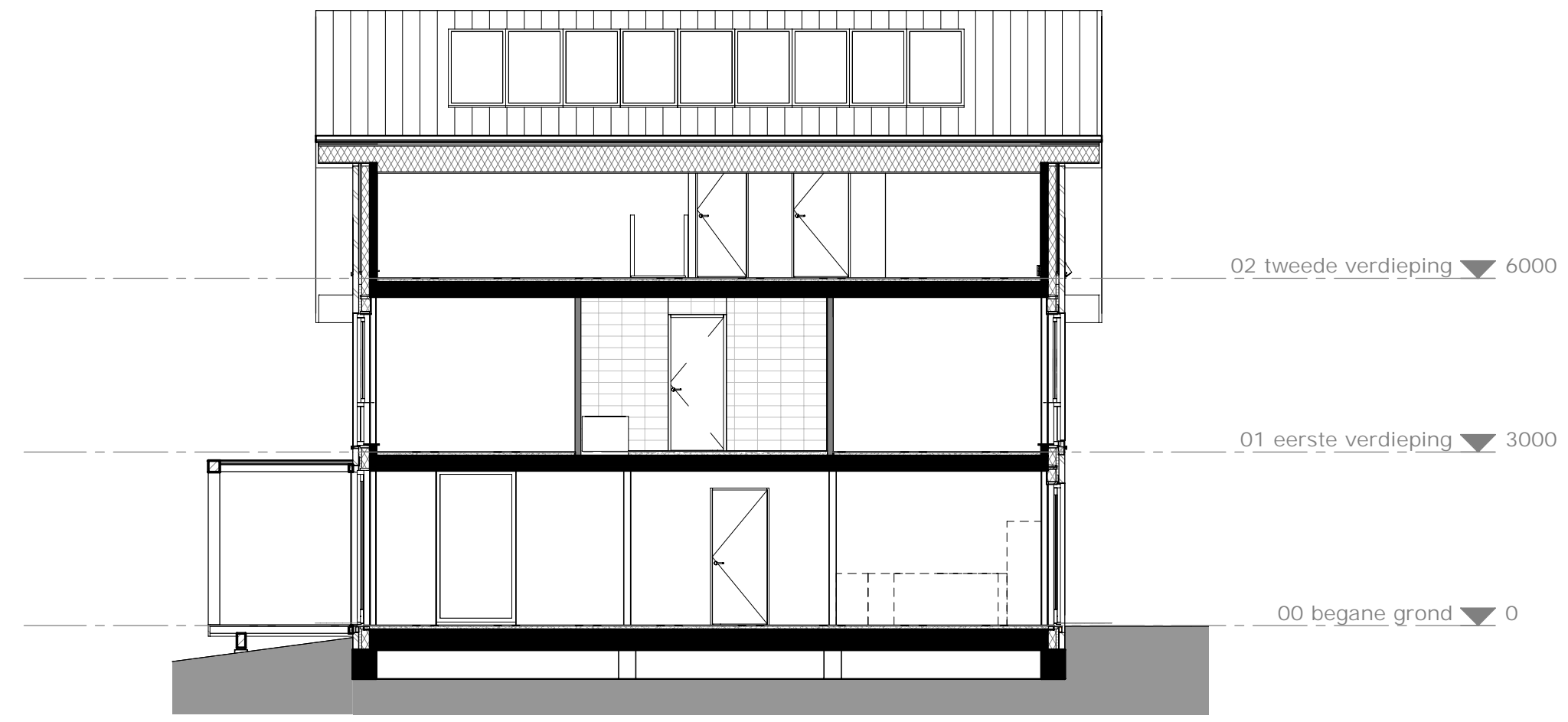

doorsnede 1

schaal 1 : 100



achtergevel

schaal 1 : 100

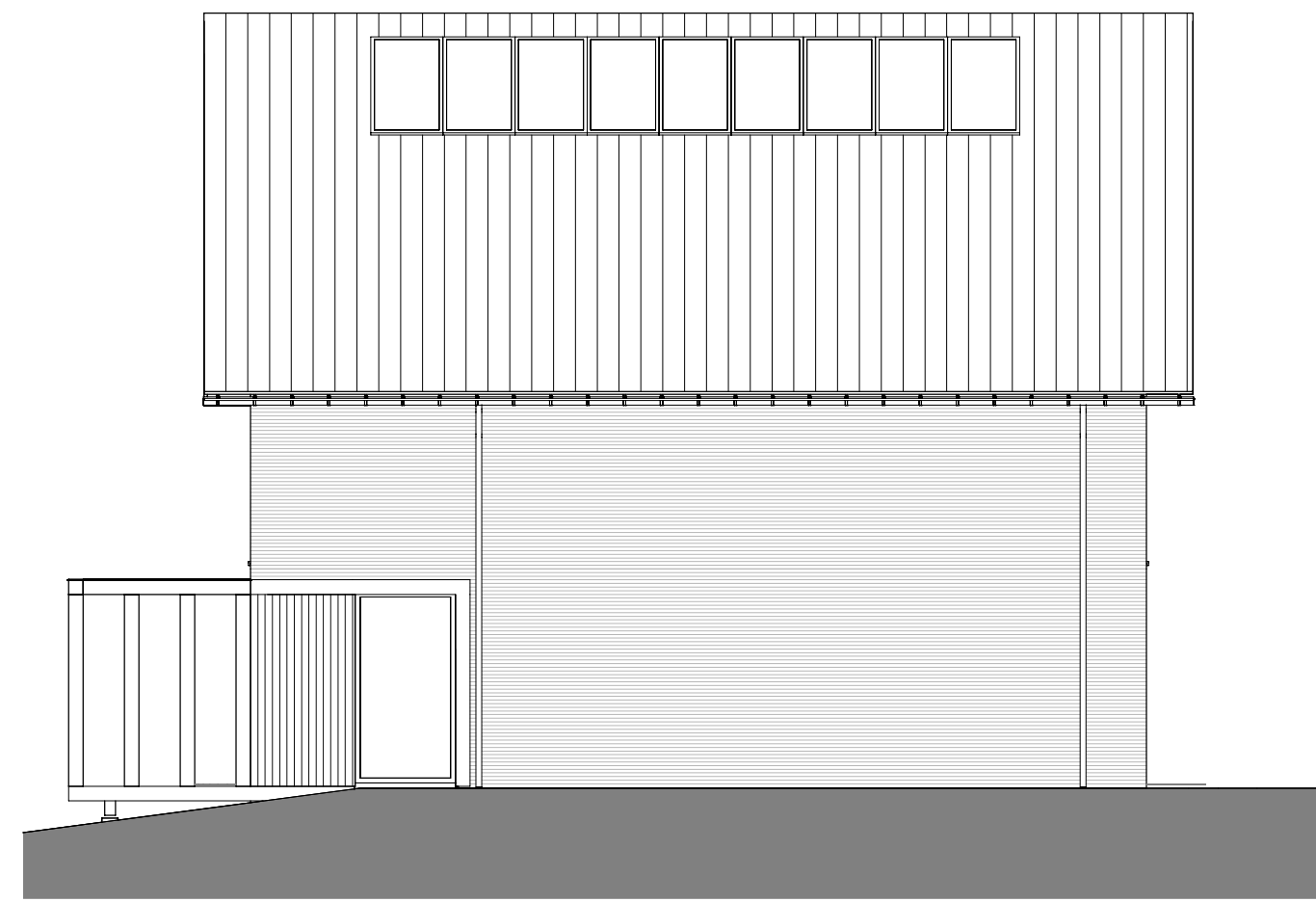

rechter zijgevel

schaal 1 : 100

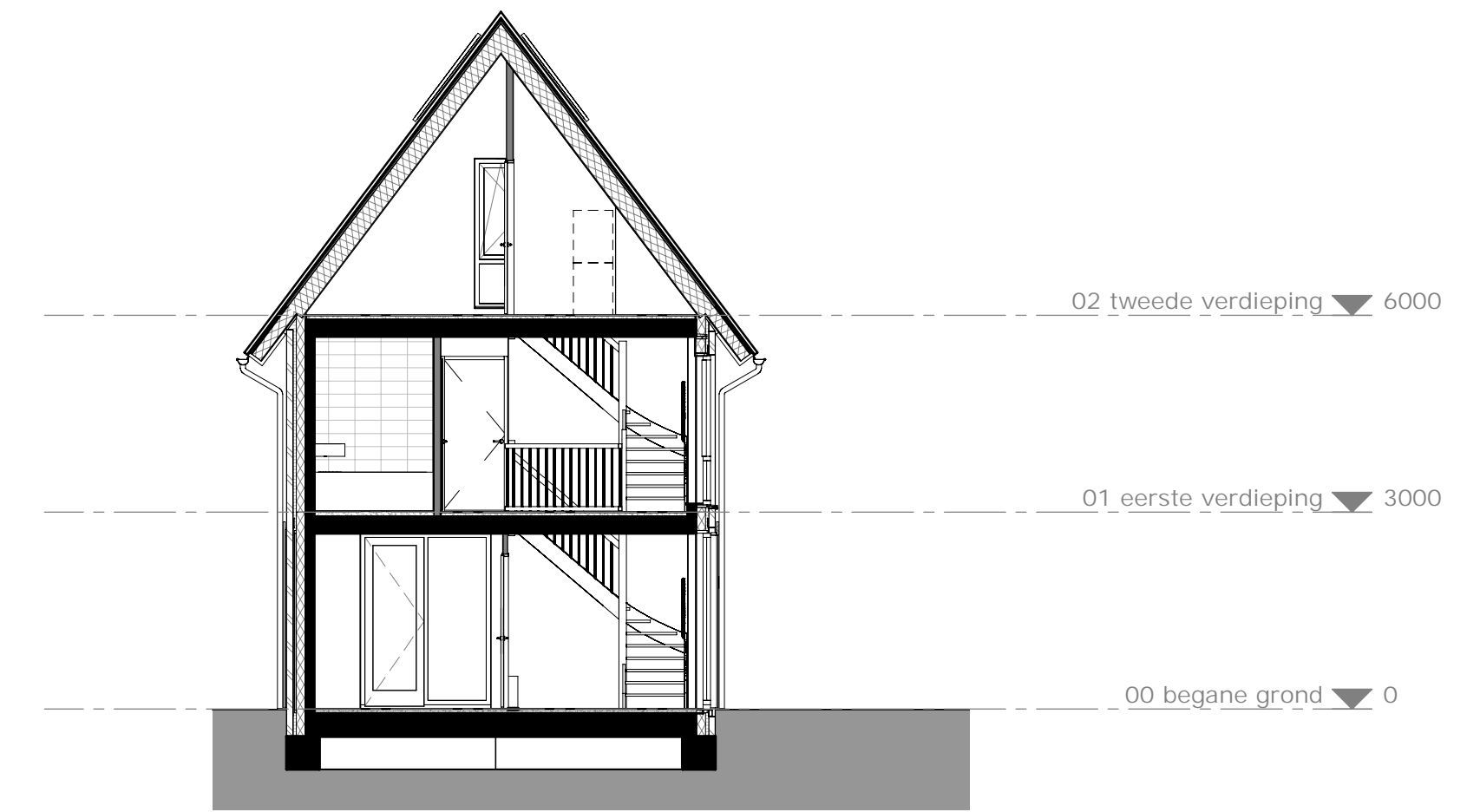





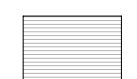



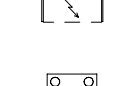
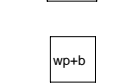

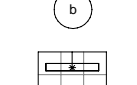
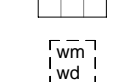



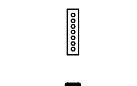
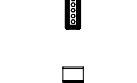

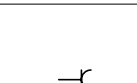
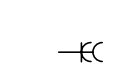
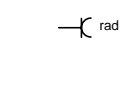
doorsnede 2

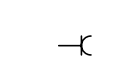
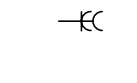
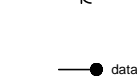
schaal 1 : 100

gevel
 metselwerk GabbroMetallic WF wldverband
 metselwerk Ogenagaat WF wldverband

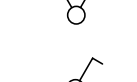
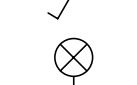
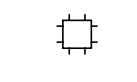
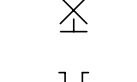
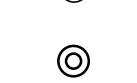
plaftegrond
 dragende constructieve wand
 isolatiemateriaal
 metselwerk, wldverband
 lichte scheidingwand

algemeen
 entree woning
 meterkast
 wtv ventilatiebox
 warmte pomp met boiler
 warmte pomp
 boiler
 douchehoek, vloer- en wandgevelwerk
 opstelplaats wasmachine, wasdroger
 hemelwaterafvoer, zink
 ventilatiepunt, in plafond
 ventilatiepunt, in wand
 rookmelder aangesloten op lichtnet
 cv verdeeler
 cv verdeeler met houten omkasting
 WTW geveelrooster

elektrotechnische installatie
 wandcontactdoos met randsaarde - 1 vouddig
 wandcontactdoos met randsaarde - 2 vouddig in compactdoos
 wandcontactdoos t.b.v. radiator
 aansluitpunt - data
 detectiepunt mechanische ventilatie
 aansluitpunt thermostaat
 aansluitpunt - onbedraad
 aansluitpunt omvormer pv panelen
 schakelaar - 1 polig
 serieschakelaar
 serie-wisselschakelaar
 buitenlichtpunt
 lichtpunt op centraaldoos, plafond
 wandlichtpunt
 deurbel
 voordeurbel

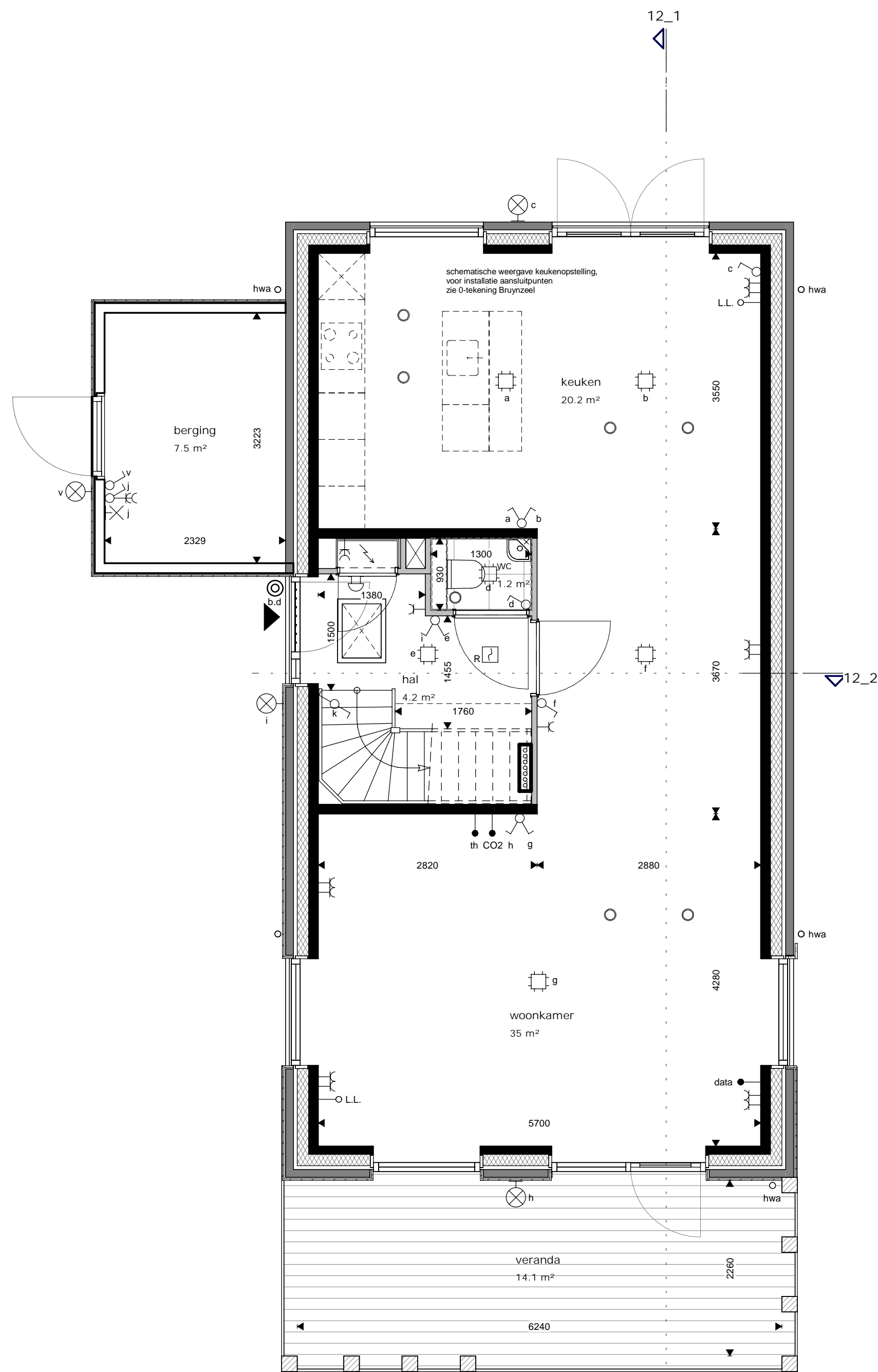

begane grond

schaal 1 : 50

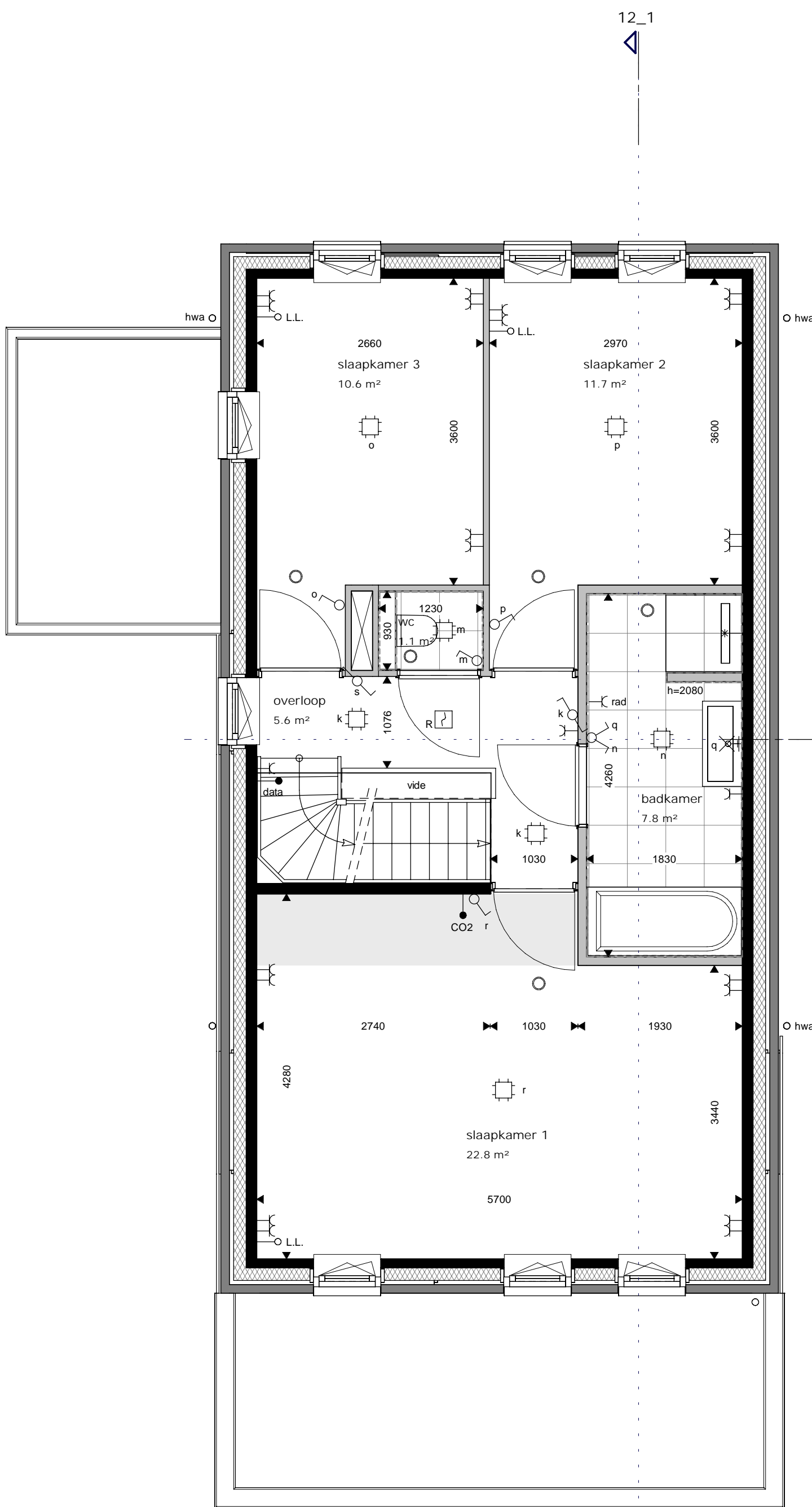

eerste verdieping

schaal 1 : 50

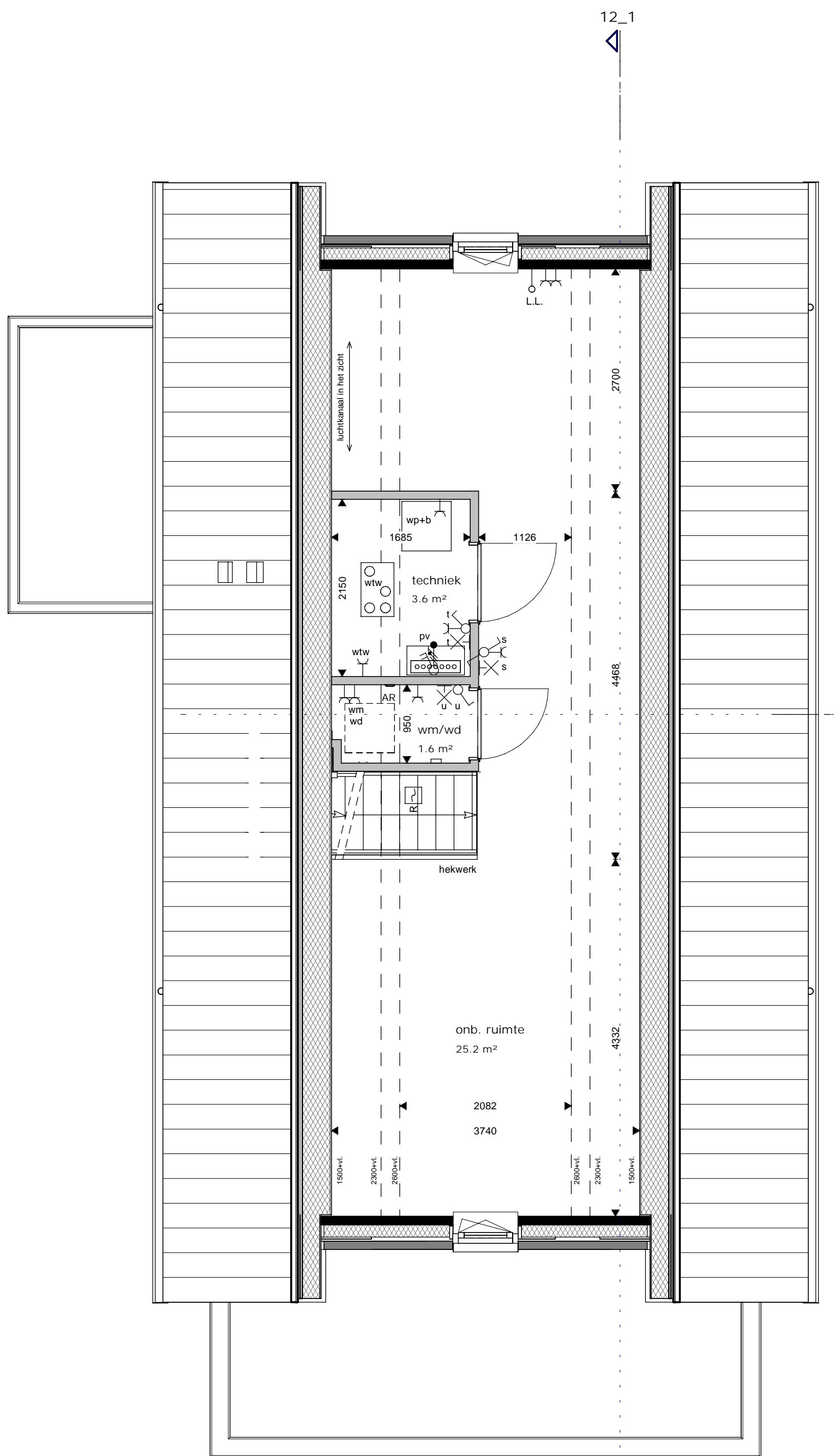

tweede verdieping

schaal 1 : 50

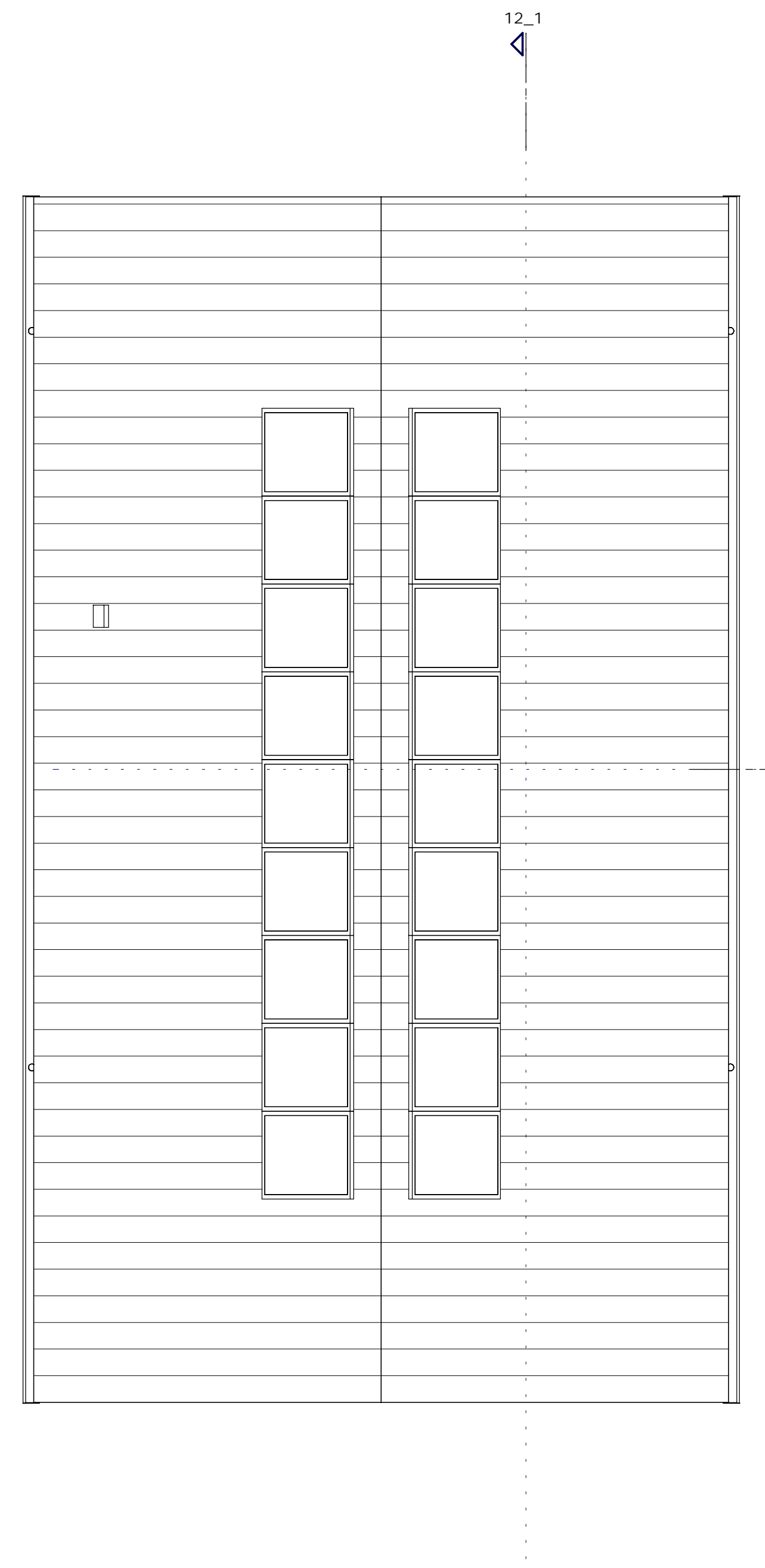

dak

schaal 1 : 50

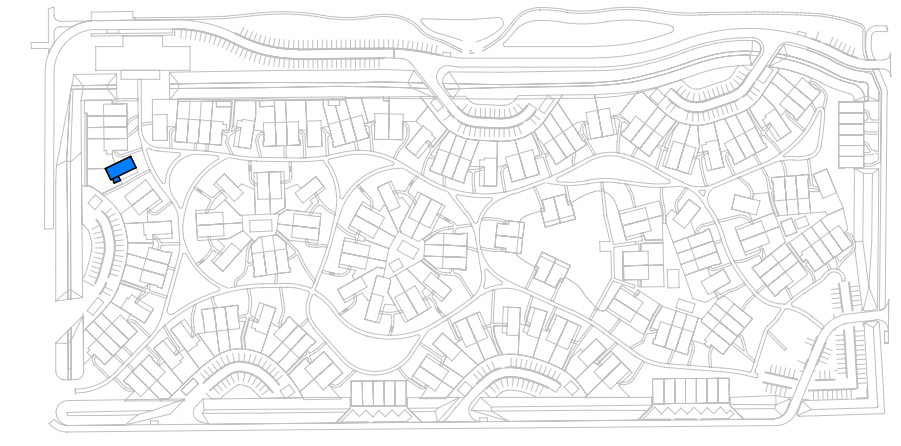

NOORD